

Legend

- PROPOSED IMPROVEMENT
- POTENTIAL CONNECTION
- CUL-DE-SAC
- MAPPED ADID WETLANDS
- PRELIMINARY INHS WETLANDS
- 100-YEAR FLOODPLAIN
- HISTORIC STRUCTURES
- MILLBURN HISTORIC DISTRICT

LakeCounty
Division of Transportation

CHRISTOPHER B. BURKE ENGINEERING LTD.
9575 West Higgins Road, Suite 600
Rosemont, Illinois 60018
(847) 823-0500

PATRICK
ENGINEERING INC.
LISLE, ILLINOIS

US ROUTE 45 - MILLBURN BYPASS

PRELIMINARY RANGE OF ALTERNATIVES - GROUP A
CAG MEETING #2 DISCUSSION

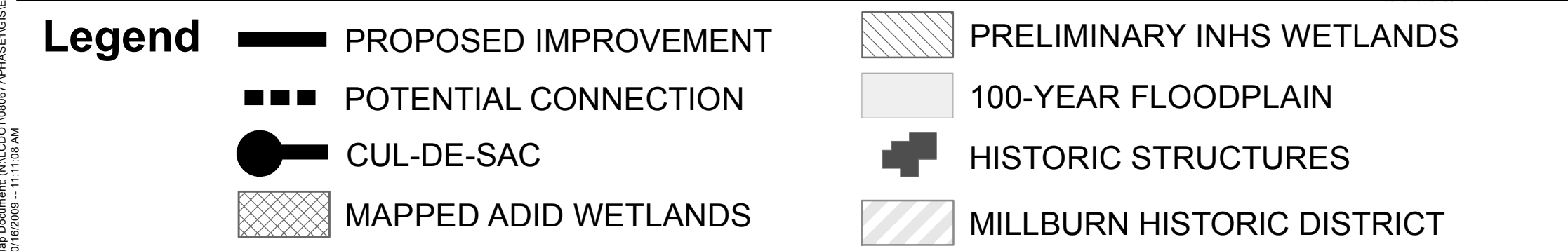
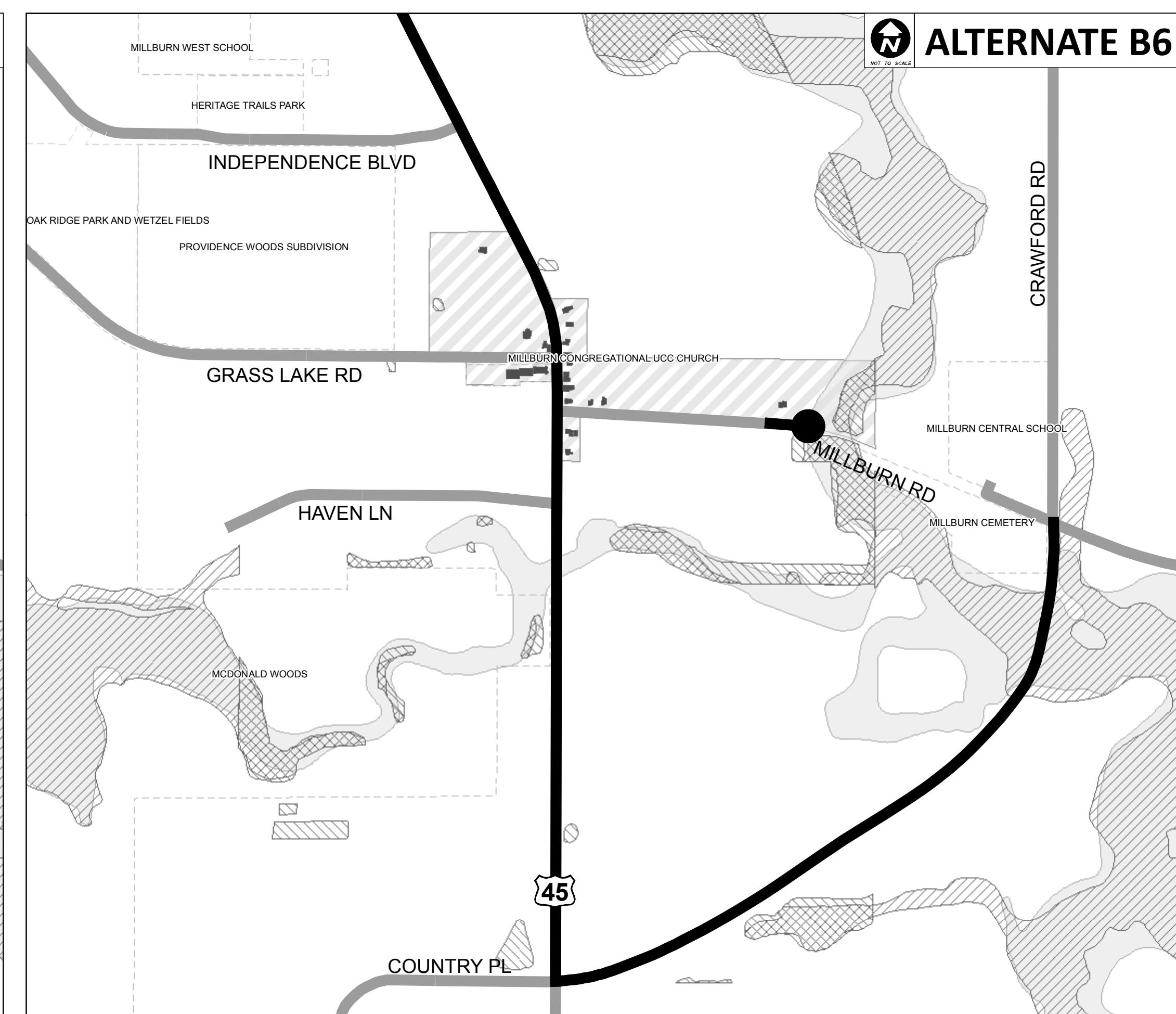
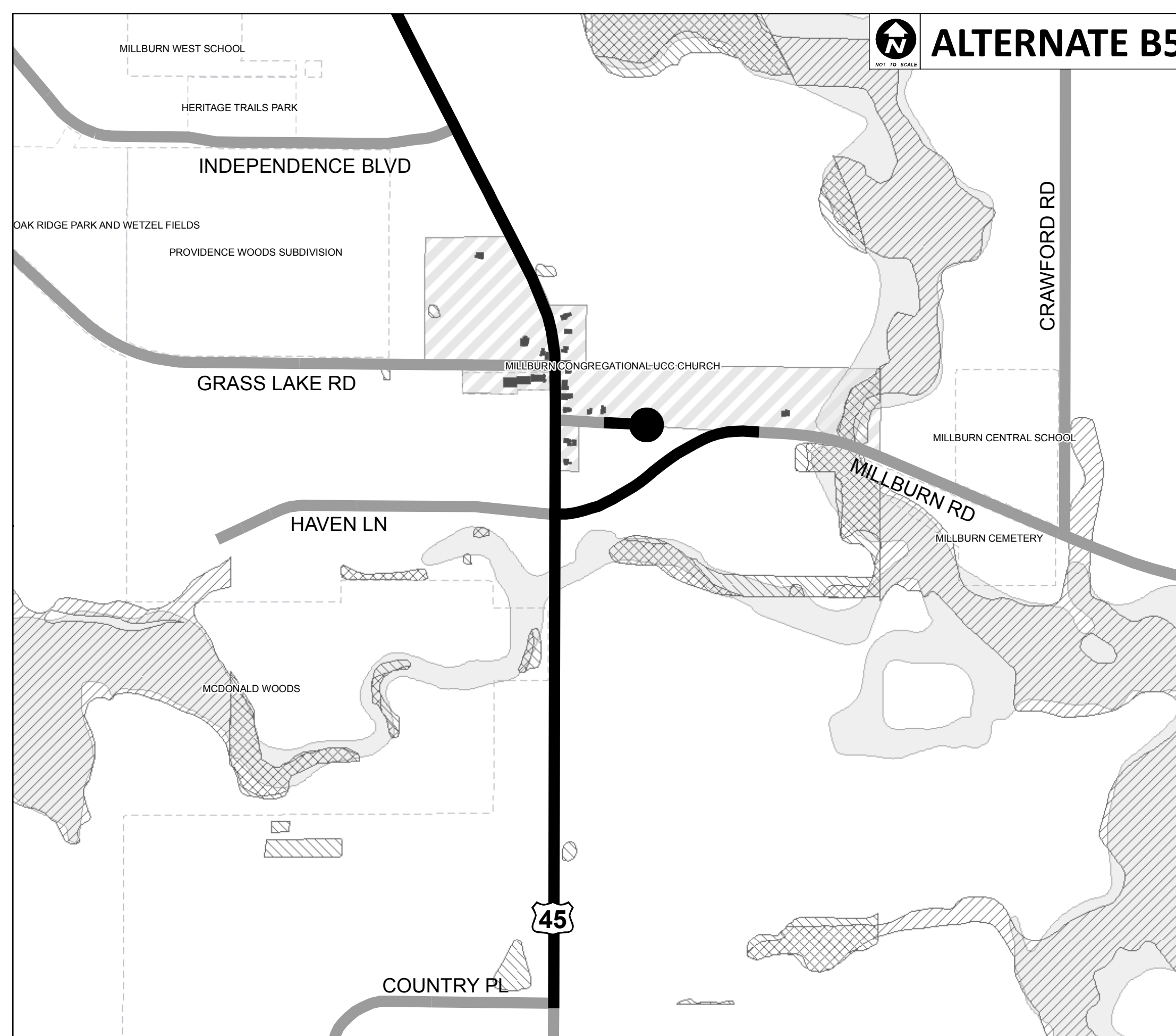
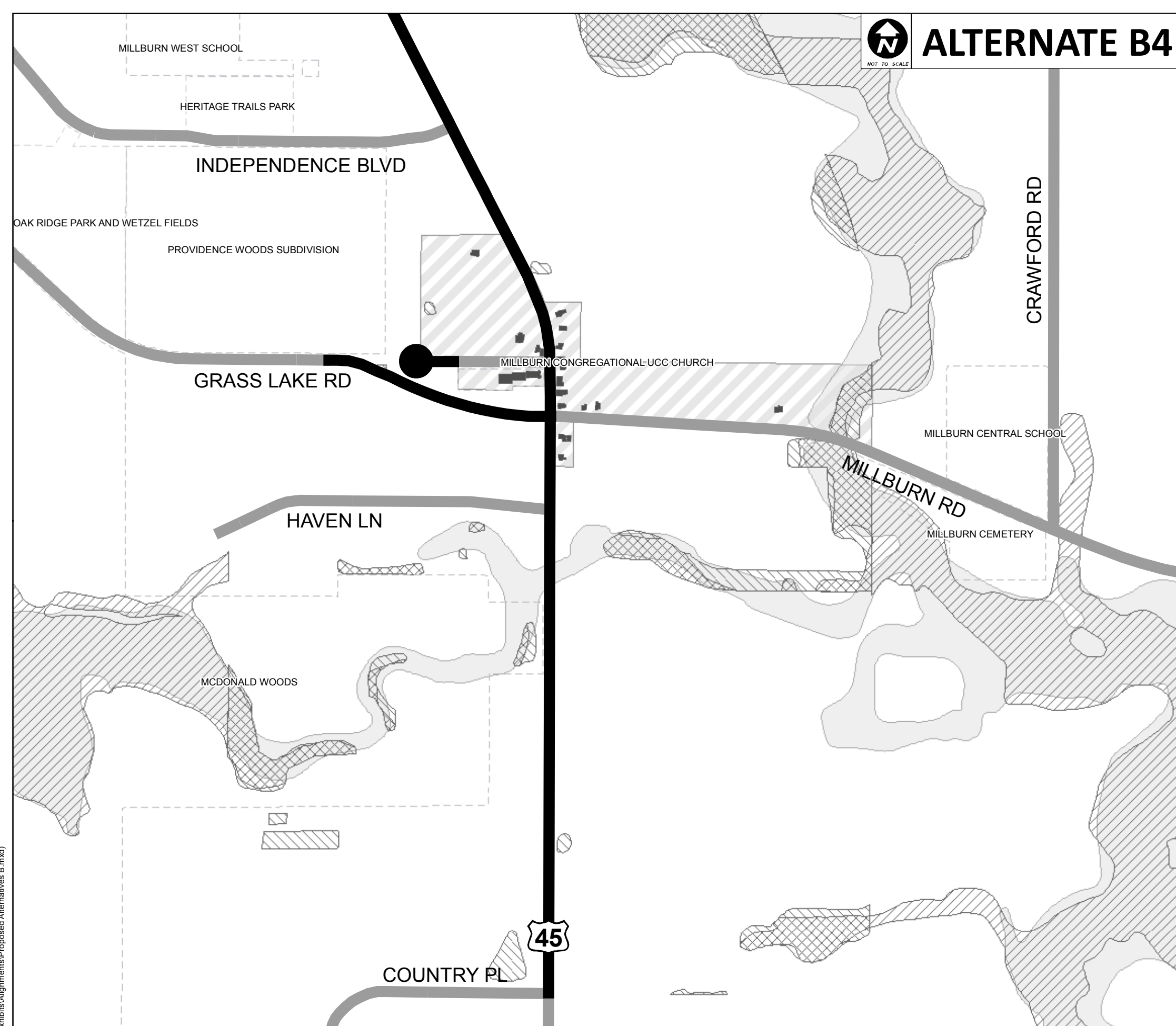
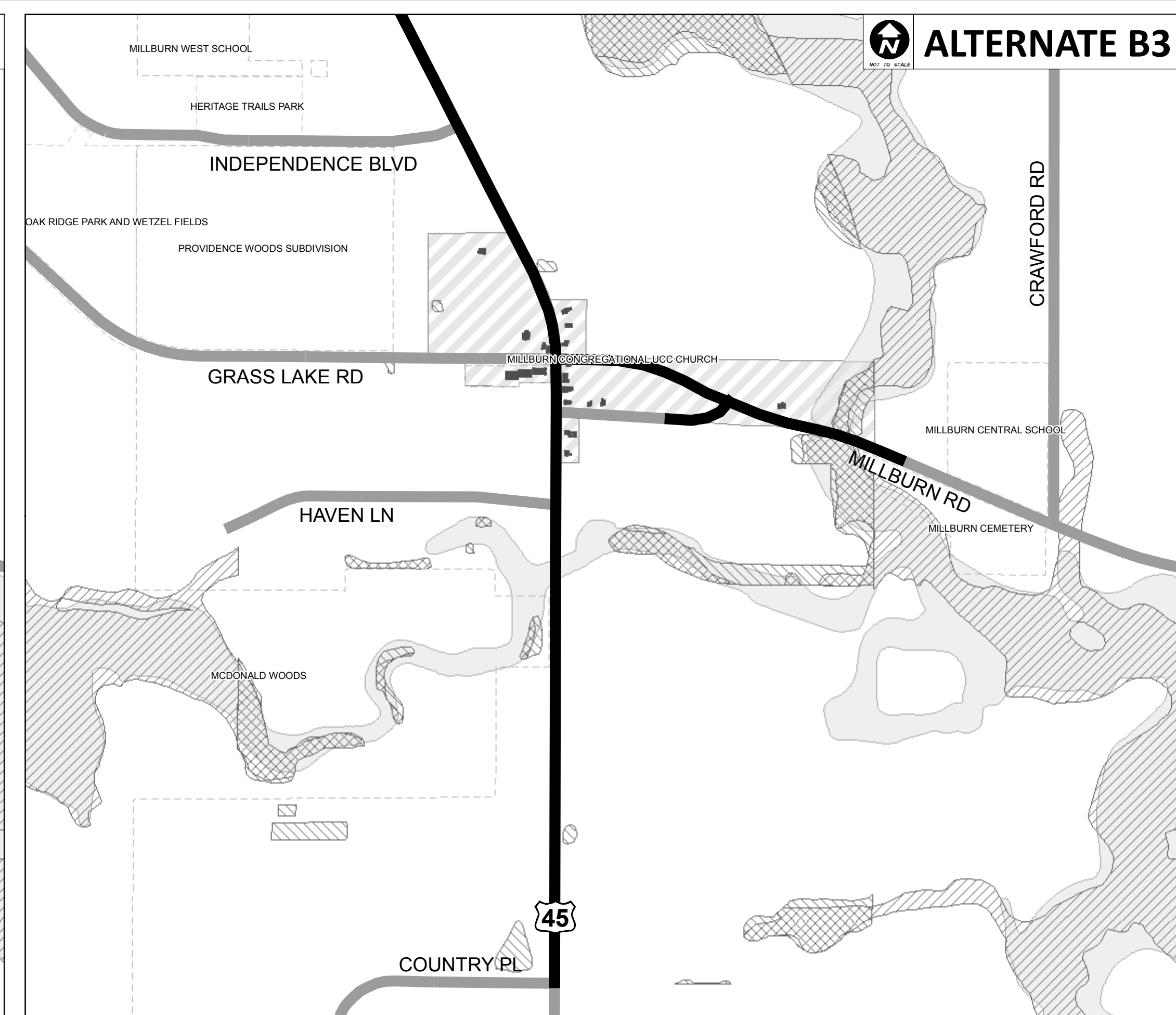
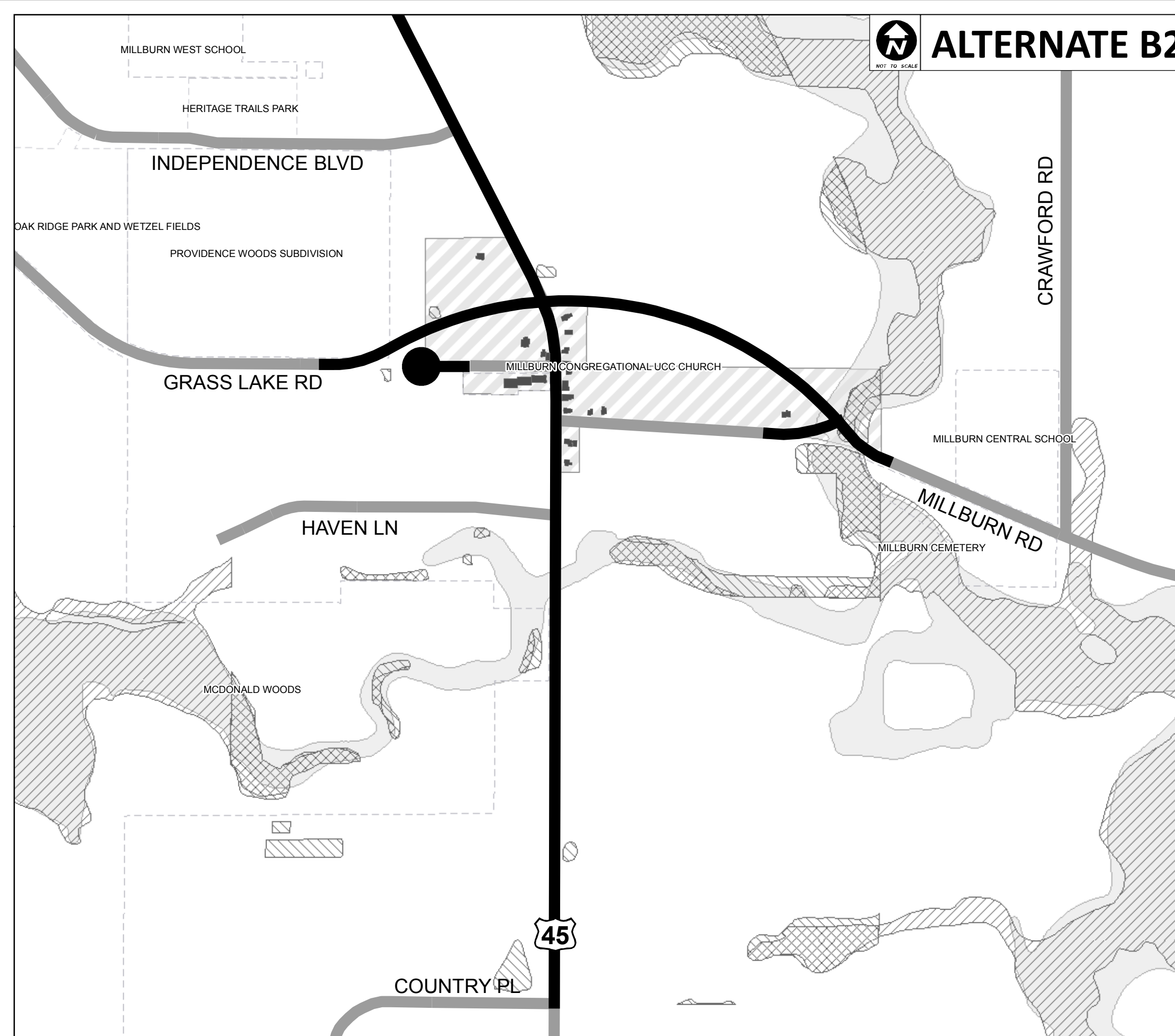
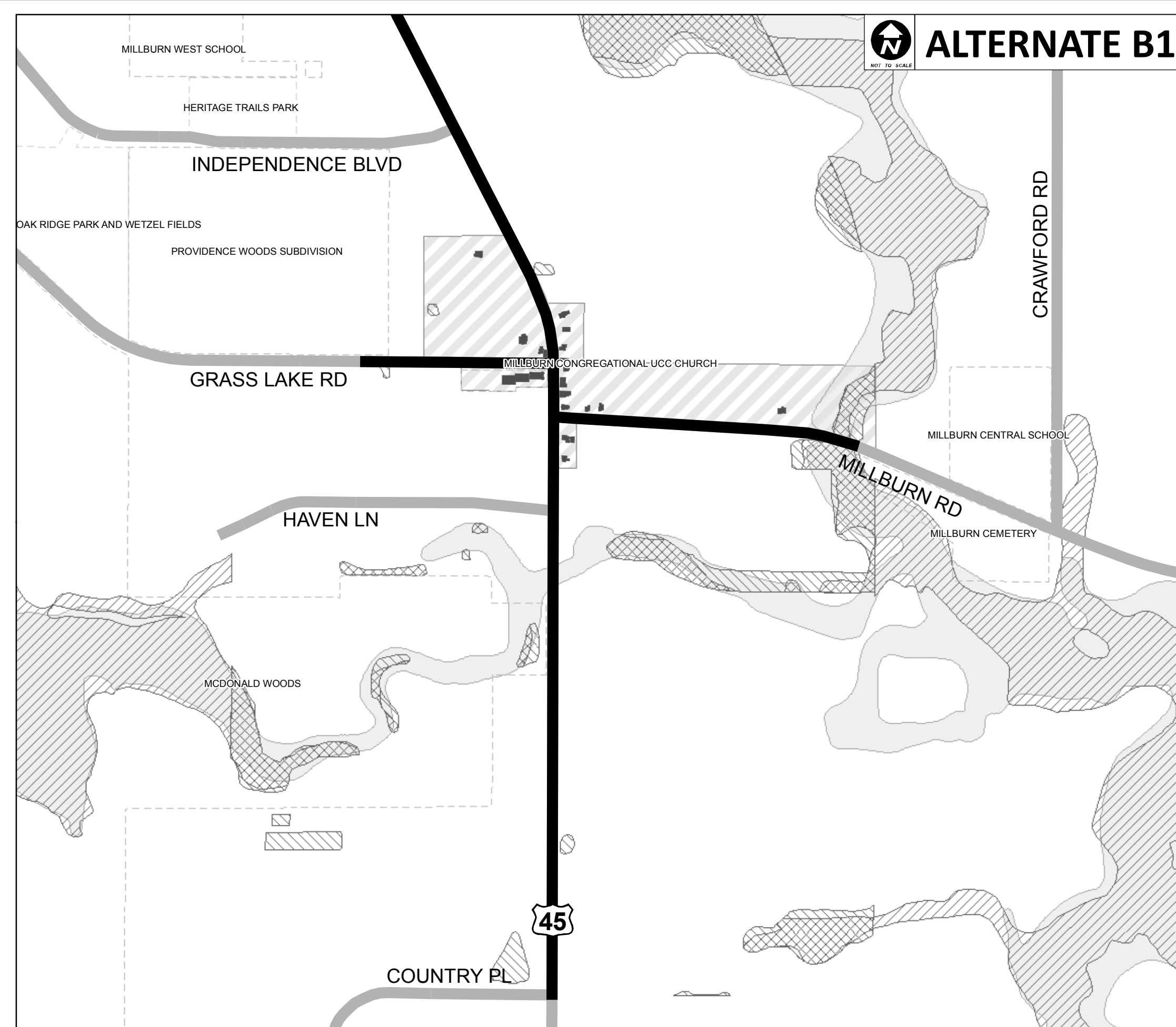

CHRISTOPHER B. BURKE ENGINEERING LTD.
 9575 West Higgins Road, Suite 600
 Rosemont, Illinois 60018
 (847) 823-0500

US ROUTE 45 - MILLBURN BYPASS

PRELIMINARY RANGE OF ALTERNATIVES - GROUP B
CAG MEETING #2 DISCUSSION

Map Document: I:\2021\08\07\774\45\45-CAG-Alternatives-Group-B.mxd
 10/16/2021 11:11:08 AM

